

BEFORE THE ILLINOIS POLLUTION CONTROL BOARD

Gervase Buehne – St. Rose	)
(Property Identification Number	) PCB 09-
01-01-28-200-001)	) (Tax Certification)
	)
	)

NOTICE

Clerk  
 Illinois Pollution Control Board  
 James R. Thompson Center  
 100 West Randolph Street, Suite: 11-500  
 Chicago IL 60601

Gervase Buehne  
 8606 Main Street  
 Breese IL 62230

Steve Santarelli  
 Illinois Department of Revenue  
 101 West Jefferson  
 Post Office Box 19033  
 Springfield IL 62794

PLEASE TAKE NOTICE that I have today filed with the Office of the Clerk of the Pollution Control Board an APPEARANCE AND THE RECOMMENDATION of the Illinois Environmental Protection Agency, a copy of which is herewith served upon you.

ENVIRONMENTAL PROTECTION AGENCY  
 OF THE STATE OF ILLINOIS

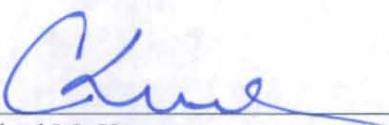
By:   
 Chad M. Kruse  
 Assistant Counsel  
 Division of Legal Counsel

DATED: January 28, 2010

Illinois Environmental Protection Agency  
 1021 North Grand Avenue East  
 Post Office Box 19276  
 Springfield IL 62794-9276  
 (217) 782-5544

THIS FILING IS SUBMITTED ON RECYCLED PAPER

BEFORE THE ILLINOIS POLLUTION CONTROL BOARD

Gervase Buehne – St. Rose  
(Property Identification Number  
01-01-28-200-001)

)  
) PCB 09-  
) (Tax Certification)  
)

A P P E A R A N C E

The undersigned, as one of its attorneys, hereby enters an APPEARANCE on behalf of Respondent,  
Illinois Environmental Protection Agency.

ILLINOIS ENVIRONMENTAL PROTECTION AGENCY

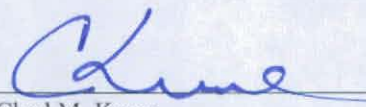
By:   
Chad M. Kruse  
Assistant Counsel  
Division of Legal Counsel

DATED: January 28, 2010  
Illinois Environmental Protection Agency  
1021 North Grand Avenue East  
Post Office Box 19276  
Springfield IL 62794-9276  
(217)782-5544

BEFORE THE ILLINOIS POLLUTION CONTROL BOARD

Gervase Buehne – St. Rose )  
(Property Identification Number ) PCB 09-  
01-01-28-200-001) (Tax Certification)  
)  
)

RECOMMENDATION

The Illinois Environmental Protection Agency (“Illinois EPA”) hereby files its Recommendation pursuant to Section 125.204 of the regulations of the Illinois Pollution Control Board, 35 Ill. Adm. Code 125.204.

1. On March 17, 2003, the Illinois EPA received a request from Buehne Farms, Inc., (log number TC-04-03, Exhibit A) for an Illinois EPA recommendation regarding the tax certification of water pollution control facilities pursuant to 35 Ill. Adm. Code 125.204.
2. The applicant’s address is: Buehne Farms, Inc.  
c/o Gervase Buehne  
8606 Main Street  
Breese IL 62230

The proposed water pollution control facilities in this request are located at Section 28, T3N, R4W of the 3<sup>rd</sup> P.M. in Clinton County, at the above street address and consist of the following:

Livestock waste management facilities consisting of: two concrete manure pits (each approximately 256 ft. x 10 ft. x 8 ft. deep) with the slotted concrete portion of the floor over the manure pits; two concrete manure pits (each approximately 156 ft. x 8 ft. x 8 ft. deep) with the slotted concrete portion of the floor over the manure pits; one concrete manure pit (approximately 60 ft. x 30 ft. x 8 ft. deep) with the slotted concrete portion of the floor over the manure pit; one concrete manure pit (approximately 60 ft. x 16 ft. x 8 ft. deep) with concrete lid; one glass lined steel storage tank with a concrete floor for manure storage (approximately 123 ft. in diameter x 19 ft. deep) with one permanent PTO driven manure transfer pump; approximately 200 linear feet of 6-inch x 6-inch concrete curbing for facilitation of manure scraping to transport manure into manure pit;

and approximately 700 feet of 6-inch diameter PVC manure transfer pipe and valves associated with said pipe.

These livestock waste management facilities are used to collect, transport and/or store livestock wastes prior to cropland application, and are further described in Exhibit A.

3. Section 11-10 of the Property Tax Code, 35 ILCS 200/11-10 (2006), defines

“pollution control facilities” as:

any system, method, construction, device or appliance appurtenant thereto or any portion of any building or equipment, that is designed, constructed, installed or operated for the primary purpose of: (a) eliminating, preventing, or reducing air or water pollution ...or (b) treating, pretreating, modifying or disposing of any potential solid, liquid or gaseous pollutant which if released without treatment, pretreatment modification or disposal might be harmful, detrimental or offensive to human, plant or animal life, or to property.

4. Pollution control facilities are entitled to preferential tax treatment, 35 ILCS 200/11-5.
5. Based on the information in the application and the purpose of the facilities, it is the Illinois EPA’s engineering judgment that the described facilities may be considered “pollution control facilities,” pursuant to 35 Ill. Adm. Code 125.200(a), with the primary purpose of eliminating, preventing, or reducing water pollution, or as otherwise provided in 35 Ill. Adm. Code 125.200, and are eligible for tax certification from the Board.
6. However, additional facilities in this request include walls and roofs of the freestall barns and the solid concrete floors in the freestall barns.
7. Based on the information in the application and the purpose of the facilities, it is the Illinois EPA’s engineering judgment that the described facilities are *not*

“pollution control facilities,” pursuant to 35 Ill. Adm. Code 125.200(a), with the primary purpose of eliminating, preventing, or reducing water pollution, or as otherwise provided in 35 Ill. Adm. Code 125.200, and are eligible for tax certification from the Board. The primary purpose of these facilities is to provide an area for animals to feed, keep the animals clean, shelter animals from outside weather conditions, reduce bedding needs and is not pollution control. Therefore, these facilities fall outside the definition of “pollution control facilities,” above, and thus are not eligible for tax certification from the Board.

8. The applicant has 35 days after the date of service of this Illinois EPA Recommendation to file a petition with the Illinois Pollution Control Board to contest this Illinois EPA Recommendation on the portion of the facility denied tax certification in paragraph 7 of Illinois EPA’s recommendation, above.

WHEREFORE, the Illinois EPA recommends that the Board issue the requested tax certification.

ILLINOIS ENVIRONMENTAL  
PROTECTION AGENCY

By:   
Chad M. Kruse  
Assistant Counsel  
Division of Legal Counsel

Dated: January 28, 2010  
Illinois Environmental Protection Agency  
1021 North Grand Ave. E.  
P.O. Box 19276  
Springfield, Illinois 62794-9276  
217/782-5544

Exhibit A



ILLINOIS ENVIRONMENTAL PROTECTION AGENCY

1021 North Grand Avenue East, P.O. Box 19276, Springfield, Illinois 62794-9276 • (217) 782-2829  
James R. Thompson Center, 100 West Randolph, Suite 11-300, Chicago, IL 60601 • (312) 814-6026

PAT QUINN, GOVERNOR

DOUGLAS P. SCOTT, DIRECTOR

Memorandum

To: Connie Tonsor, Division of Legal Counsel

From: Al Keller, P.E., Manager, Permit Section

Date: December 15, 2009

Re: Gervase Buehne – St. Rose  
Recommendation of Tax Certification/Recommendation of Tax Certification Denial  
Log # TC-04-03  
Property Identification # 01-01-28-200-001

RECEIVED  
Division of Legal Counsel  
DEC 16 2009  
Environmental Protection Agency

The Bureau of Water received a request on March 17, 2003 from Gervase Buehne for an Illinois EPA recommendation regarding the tax certification of water pollution control facilities pursuant to 35 Il. Adm. Code 125.204. We offer the following recommendation.

The water pollution control facilities in this request include the following:

Gervase Buehne  
8606 Main Street  
St. Rose, IL 62230

Section 28, T3N, R4W of the 3<sup>rd</sup> P.M. in Clinton County

Livestock waste management facilities consisting of:

- Two concrete manure pits (each approximately 256 ft. x 10 ft. x 8 ft. deep) with the slotted concrete portion of the floor over the manure pits;
- Two concrete manure pits (each approximately 156 ft. x 8 ft. x 8 ft. deep) with the slotted concrete portion of the floor over the manure pits;
- One concrete manure pit (approximately 60 ft. x 30 ft. x 8 ft. deep) with the slotted concrete portion of the floor over the manure pit;
- One concrete manure pit (approximately 60 ft. x 16 ft. x 8 ft. deep) with concrete lid;
- One glass lined steel storage tank with a concrete floor for manure storage (approximately 123 ft. in diameter x 19 ft. deep) with one permanent PTO driven manure transfer pump;
- Approximately 200 linear feet of 6-inch x 6-inch concrete curbing for facilitation of manure scraping to transport manure into manure pit;
- And approximately 700 feet of 6" diameter PVC manure transfer pipe and valves associated with said pipe.

These livestock waste management facilities are used to collect, transport and/or store livestock wastes prior to cropland application.

These facilities are further described in the enclosed applications and supporting documents.

Based on the information included in this submittal, it is our engineering judgment that the above proposed facilities may be considered "Pollution Control Facilities" under 35 IAC 125.200(a), with the primary purpose of eliminating, preventing, or reducing water pollution, or as otherwise provided in this section, and therefore eligible for tax certification from the Illinois Pollution Control Board. The Bureau of Water therefore recommends that the Board issue the requested tax certification for these facilities.

Additional facilities in this request include:

- Walls and roofs of the freestall barns and the solid concrete floors in the freestall barns.

These facilities are further described in the enclosed applications and supporting documents.

Based on the information included in this submittal, the Bureau of Water has determined that the facilities are not "Pollution Control Facilities" under 35 IAC 125.200(a), with the primary purpose of eliminating, preventing, or reducing water pollution, or as otherwise provided in this section. This determination is based on the following factor(s):

The primary purpose of these facilities is to provide an area for animals to feed, keep the animals clean, shelter animals from outside weather conditions, reduce bedding needs and is not pollution control.

The Bureau of Water therefore recommends that the Board deny the requested tax certification for these facilities.

If you have any questions regarding the above, please contact Thaddeus Faught at 217/782-3362.

SAK:TJF:TC-04-03.docx

cc: Tax Cert File

Watershed Unit Tax Certification Review Sheet

Project Name: Gervase L. + Norma Buehne Trust Location: St. Rose  
 Reviewer: David Ginder TJE (12/10/09) Date: 12-5-03 12/10/09/TJE  
 Log No.: TC-04-03 Type:  Agchem  
 Livestock

Applicant: Gervase L. + Norma Buehne Trust Contact: Gervase Buehne  
Gervase Buehne Phone: 618/526-4678  
8.606 Main St.  
St. Rose, IL 62230

Facility: same as applicant address Property ID: 01-01-28-200-001

Legal Description: Section 28, T3N, R4W of County: Clinton  
the 3<sup>rd</sup> P.M.

Date Control Devices Installed: 10-31-01 Provided Fair Cash Value: Yes

Signature: Gervase Buehne Title: President

Wastes:  Livestock waste is applied to cropland.  
 Agrichemical rinsate and spillage is recycled through the facility and/or land applied.  
 Other: \_\_\_\_\_

Physical Description of Pollution Control Devices:  
see attached sheet + notes

Other: \_\_\_\_\_



Subject Gervase Buehne - St. RoseData TC-04-03Reviewed by Theodore FaylerDate 12/6/09

facilities include:

- one glass-lined steel slurry store with concrete floor (123 ft diameter x 19 ft high) in initial application and plan sheet
- two concrete manure pits (each 256 ft x 10 ft x 8 ft deep) w/ concrete slats in initial application and plan sheet in "proposed" freestall Barn
  - note: pits extend ≈ 4 ft in each direction out of 248 ft building (see large plans)
- two concrete manure pits (each 156 ft x 8 ft x 8 ft deep) w/ concrete slats in response/plans received 4/29/05 and plan sheet in "existing" freestall Barn
  - note: pits extend ≈ 4 ft in one direction out of 152 ft building (see plans received 4/28/05)
- one concrete manure pit (60 ft x 16 ft x 8 ft deep) w/ concrete lid (concrete lid in initial application (in "cow lot") and plan sheet as "manure pit" indicated in David Ginder's 4/7/05 notes)
- one concrete manure pit (60 ft x 30 ft x 8 ft deep) w/ concrete slats in plan sheet as "proposed 30x60x8 pit"; concrete slats indicated in item 6 of response received 1/13/05
- 700 ft of 6 inch diameter PVC manure transfer pipe indicated in initial application, plan sheet, and item 7 of response received 1/13/05
- one permanent PTO driven manure transfer pump in item 8 of response received 1/13/05 and David Ginder's 4/7/05 notes (at slurry store)
- 200 linear feet of 6 inch x 6 inch concrete curb around the cow lot in response received 4/29/05 and David Ginder's 4/7/05 notes.

Subject Gervase Buehne - St. RoseData TC-04-03Reviewed by David Ginder Date 4-7-05

Responses to the 11-17-04 review letter:

① ok Section 28, T3N, R4W of the 3rd P.M.

② ok October 31, 2001

③ \$ 195,146.00

→ Multiple free stall buildings? Pits?  
Revise figure?

④ Multiple new buildings? See Item 7 plan view drawing

⑤ ok Reinforced Portland Cement Concrete Base

⑥ ok Details provided for the Cow Lot Pit

⑦ ok 700' of 6"  $\phi$  PVC pipe (Schedule 40)

⑧ PTO-driven manure transfer pumps

→ #? 4/11/05 Gervase Buehne - 2 pumps

→ Permanent or portable?

1- permanent @ steel tank

1- portable to agitate & pump from pits  
to steel tank.

Subject Gervase Buehne - St. RoseData TC-04-07Reviewed by David GinderDate 4-7-05

⑨ ok There are valves, not manure drain pull plugs.

4-11-05 I spoke to Mr. Buehne. Mr. Buehne is to provide the following:

- Drawings & revised fair cash value for the existing manure pit & existing free stall barn (8'x8' pits/slats)
- The fair cash value for the curbing around the cow lot + to verify that the cost of the cow lot has not been included in the provided fair cash value information.

Note: The existing manure pit does ~~not~~ have slatted flooring over the pit - they scrape into the pit.

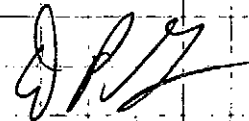

\*\*\*\*\* PCB 2010-056 \*\*\*\*\*

BUEHNE FARMS, INC.  
8606 MAIN STREET  
BREESE, IL 62230

FACSIMILE TRANSMITTAL SHEET

TO: Rick Breckenridge	FROM: Gervase Buehne
COMPANY: Local Government Ser.	DATE: 11/30/09
FAX NUMBER: 217-557-2125	TOTAL NO. OF PAGES INCLUDING COVER: 18
PHONE NUMBER: Cell 217-720-8025	SENDER'S PHONE NUMBER: (618) 526-4678
RE:	YOUR FAX NUMBER: (618) 526-4678

URGENT    FOR REVIEW    PLEASE COMMENT    PLEASE REPLY    PLEASE RECYCLE

NOTES/COMMENTS:

Hope this is what you need.  
 Let me know what now we need  
 to do. I thought this was all taken  
 care of, but now I would like to  
 get it cleared up, as soon as possible.  
 Thank You

**RECEIVED**  
 NOV 30 2009  
 Watershed Management Section  
 BUREAU OF WATER

CONFIDENTIALITY NOTE

The information contained in this facsimile transmission is legally privileged and confidential information intended only for the use of the individual or entity named above. If the reader of this transmission is not intended recipient, you are hereby notified that any dissemination, distribution or copying of this transmission is strictly prohibited. If you have received this transmission in error, please immediately notify us by collect telephone call and return the original transmission to us at the address above via U.S. Mail. Thank You.



George H. Ryan, Governor • Joe Hampton, Director

**Bureau of Environmental Programs**

Slate Fairgrounds • P.O. Box 19281 • Springfield, IL 62794-9281 • 217/785-2427 (voice/TDD) • Fax 217/524-4882  
Pesticide Misuse Hotline 1-800-641-3934 (voice/TDD)

**LIVESTOCK WASTE PROGRAM**  
**FINAL NOTICE OF CONSTRUCTION PLAN COMPLETION**  
*Non-Lagoon Livestock Waste Handling Facility*

**Registrant:**

Buehene Farms, Inc.  
8606 Main Street  
Breese, IL 62230

**Facility Location:**

Breese  
**Facility ID#:**  
LF0270:20000

**Date Issued: October 19, 2001**

The Department has received a certification notice from the owner or operator relative to the completion of construction of a non-lagoon livestock waste handling structure at the aforementioned facility. The certification indicates that the waste handling structure has been constructed or modified in accordance with the requirements of the Livestock Management Facilities Act (Act) (510 ILCS 77/1 et seq.) and rules and that the information provided during the registration process is correct.

On October 12, 2001, Department representatives conducted a final inspection at the facility pursuant to the Livestock Management Facilities Act (510 ILCS 77/13 (g)). No deviations from the construction plan were noted during the inspection. Inspections of the facility were also conducted prior to and during the construction phase of the project.

Pursuant to the Section 13 of the Livestock Management Facilities Act, the construction plan and certification requirements of the Act have been met. The owner or operator of the livestock waste handling facility may proceed to place the structure into service.

If you have any questions or if the Department may be of service to you, please feel free to contact us at 217/785-2427.

Sincerely,

ILLINOIS DEPARTMENT OF AGRICULTURE

Warren D. Goetsch, P.E.  
Administrator, Division of Natural Resources

Scott J. Frank  
Bureau Chief, Environmental Programs

cc: file  
Tim Kluge, IEPA

LF027022cpfinal



Illinois  
Environmental  
Protection Agency

Bureau of Water  
P.O. Box 19276  
Springfield, IL 62794-9276

August 2000

## Tax Certification Program for Livestock Waste Management Facilities

As an incentive for livestock producers to construct waste storage structures and other structures which prevent water pollution the Agency administers a tax certification program, which reduces the property tax value for many pollution control improvements. In order to recognize this tax reduction, the producer must have the improvement certified by the Illinois Environmental Protection Agency (Illinois EPA) as a pollution control facility.

Various facilities have been determined to meet the definition of a pollution control facility for livestock waste management. The following are examples of pollution control facilities for livestock waste management.

1. Manure pits under confined animal feed structures.
2. Slatted floors over manure pits.
3. Floors (not in feeding areas) specifically designed to collect and transport livestock wastes to liquid waste storage facilities.
4. Liquid livestock waste storage facilities including, but not limited to: tanks, lagoons, and holding ponds.
5. Dry manure stacking structures.
6. Feedlot runoff sediment capture basins.
7. Vegetative filter systems including, but not necessarily limited to those components designed, constructed and operated pursuant to Title 35 Illinois Administrative Code, Subtitle E, Chapter 11, Part 570 titled Design and Maintenance Criteria Regarding Runoff Field Application Systems adopted August 3, 1982.
8. Structures or other devices used specifically to divert uncontaminated runoff and roof drainage away from animal feeding facilities so as to minimize the production of feedlot runoff.
9. Roof structures specifically intended to prevent precipitation from entering livestock waste storage facilities provided that such a roof shall meet the requirement that animal feeding operations are not and also could not be normally conducted below said roof.
10. Building or structure walls specifically intended to support those roof structures described in item #9 above.
11. Tanks or other similar structures, such as methane digesters, that are specifically designed, constructed and operated for the only purpose of reducing odors from livestock wastes provided that such facilities shall meet the requirement that methane or products other than processed animal manures are not produced or collected for utilization in any purpose other than the normal operation of the facility.
12. Specific appurtenances to those facilities listed above such as pumps, pump pits, manure scrapers, ramps, manure stackers, or other devices provided that such appurtenances are designed, constructed and operated for the primary purpose of the normal operation of the pollution control facility.
13. Other facilities that meet the definition of a pollution control facility.

Once Illinois EPA has certified that the improvements made by the producer qualify as a pollution control facility, the Agency submits a copy of the certification to the producer and the Illinois Department of Revenue (IDOR). The IDOR assumes authority from the county tax assessment office to assess the value of the certified facilities based upon remaining useful lifetime and the salvage value (usually property taxes are based upon fair cash value). This reduces the assessed value of the certified facilities and, therefore, the property tax.

The date upon which the Illinois EPA received an application form from a producer determines the first assessment year that the IDOR assumes assessment jurisdiction from the county.

Pollution control facilities certified by the Illinois EPA will be assessed by the IDOR as of January 1 of the year after Illinois EPA's receipt of the tax certification application. For instance, if an application is received by the Illinois EPA on January 1, 1999, or December 31, 1999, both would come under the IDOR's assessment jurisdiction as of January 1, 2000.

\*\*\*\*\* PCB 2010-056 \*\*\*\*\*

CT

**APPLICATION FOR CERTIFICATION (PROPERTY TAX TREATMENT)  
POLLUTION CONTROL FACILITY**  
AIR  WATER

ILLINOIS ENVIRONMENTAL PROTECTION AGENCY  
P. O. Box 19276, Springfield, IL 62794-9276

This Agency is authorized to request this information under Illinois Revised Statutes, 1979, Chapter 120, Section 502a-5. Disclosure of this information is voluntary. However, failure to comply could prevent your application from being processed or could result in denial of your application for certification.

FOR AGENCY USE

File No.	Date Received	Certification No.	Date	
Sec. A  APPLICANT	Company Name <i>BUEHNE FARMS, INC.</i>			
	Person Authorized to Receive Certification <i>GERVASE BUEHNE</i>		Person in Contact for Additional Details <i>GERVASE BUEHNE</i>	
	Street Address <i>8606 MAIN ST.</i>		Street Address <i>8606 MAIN ST.</i>	
	Municipality, State & Zip Code <i>BREESE, IL 62230</i>		Municipality, State & Zip Code <i>BREESE, IL 62230</i>	
	Telephone Number <i>618-526-4678</i>		Telephone Number <i>618-526-4678</i>	
	Location of Facility Quarter Section      Township      Range <i>N1E SECT 18      3N      4W</i>		Municipality <i>N/A</i>	Township <i>ST. ROSE</i>
	Street Address <i>8606 MAIN ST.</i>		County <i>CLINTON</i>	Book Number
	Property Identification Number		Parcel Number	
Sec. B  MANUFACTURING OPERATIONS	Nature of Operations Conducted at the Above Location  <i>DAIRY</i>			
	Water Pollution Control Construction Permit No.		Date Issued	
	NPDES PERMIT No.		Date issued	Expiration Date
	Air Pollution Control Construction Permit No.		Date Issued	
	Air Pollution Control Operating Permit No.		Date issued	
Sec. C  MANUFACTURING PROCESS	Describe Unit Process			
	Materials Used in Process			
Sec. D  POLLUTION CONTROL FACILITY DESCRIPTION	Describe Pollution Abatement Control Facility  <i>SEE ATTACHMENTS</i>			



ILLINOIS ENVIRONMENTAL PROTECTION AGENCY

1021 NORTH GRAND AVENUE EAST, P.O. BOX 19276, SPRINGFIELD, ILLINOIS 62734-9276, 217-782-3397  
JAMES R. THOMPSON CENTER, 100 WEST RANDOLPH, SUITE 11-300, CHICAGO, IL 60601, 312-814-6026

217782-3362

ROD R. BLAGOJEVICH, GOVERNOR

RENEE CIPRIANO, DIRECTOR

November 17, 2004

Gervase L. Buehne  
Gervase L. and Norma Buehne Trust  
8,606 Main Street  
St. Rose, Illinois 62230

Re: Illinois Property Tax: Gervase L. and Norma Buehne Trust - St. Rose  
Livestock Waste Management Facilities  
Log No. TC-04-03

Gentlemen:

The application for Illinois Property Tax Certification received March 17, 2003 for the above listed facilities has been reviewed and the following is offered for your consideration and appropriate action.

1. Please provide the location by section, township and range in numeric form (i.e., Section 2, T23N, R6E) for the property where the livestock facilities are located.
2. Please provide the date when construction was completed for the livestock waste management structures for which property tax certification is sought.
3. Please provide the fair cash value of the livestock waste management facilities for which property tax certification is sought as requested by item (5) in Section E of the application form.
4. Please include complete dimensions (length, width, depth, diameter, etc.) and the materials of construction (concrete, steel, plastic, PVC, etc.) for the manure pits and slotted floor located over the manure pits in the Free Stall Barn.
5. Please indicate if the manure holding tank (123 ft. in diameter and 19 ft. in height) has a reinforced Portland Cement Concrete base.
6. Please indicate if certification is sought for the manure pit associated with the Cow Lot. If so, please indicate the dimensions and materials of construction of the manure pit. Please indicate if slotted flooring exists over the Cow Lot manure pit and specify the material of construction for such slotted flooring. Please indicate how manure enters the Cow Lot pit (i.e., scraped, through slotted flooring, gravity, etc.)
7. Please indicate the total length, diameter and material of construction of the manure transfer piping associated with the pits located under the Free Stall Barn, the manure holding tank (123 ft. in diameter and 19 ft. in height) and the Cow Lot pit.
8. Please indicate if any manure transfer pumps are associated with the manure holding tank, the manure pits located under the Free Stall Barn and the Cow Lot manure pit. If so, please indicate if the pumps are engine driven, electrically driven or pto-driven.



\*\*\*\*\* PCB 2010-056 \*\*\*\*\*

Tax Certification Application

Mr Dan Heacock

1-217-782-3362

6-11-04 talked to Susan Yurkin

Susan filed 3-17-03 not

yet processed. Mr. Yurkin

will receive app. to reissue

A.S.A.P. probably within 3 months.

this year for due.

Tax Certification Application

Mr Heacock

1-317-782-3362

Don

1-317-785-1225

1-317-785-1225

\*\*\*\*\* PCB 2010-056 \*\*\*\*\*

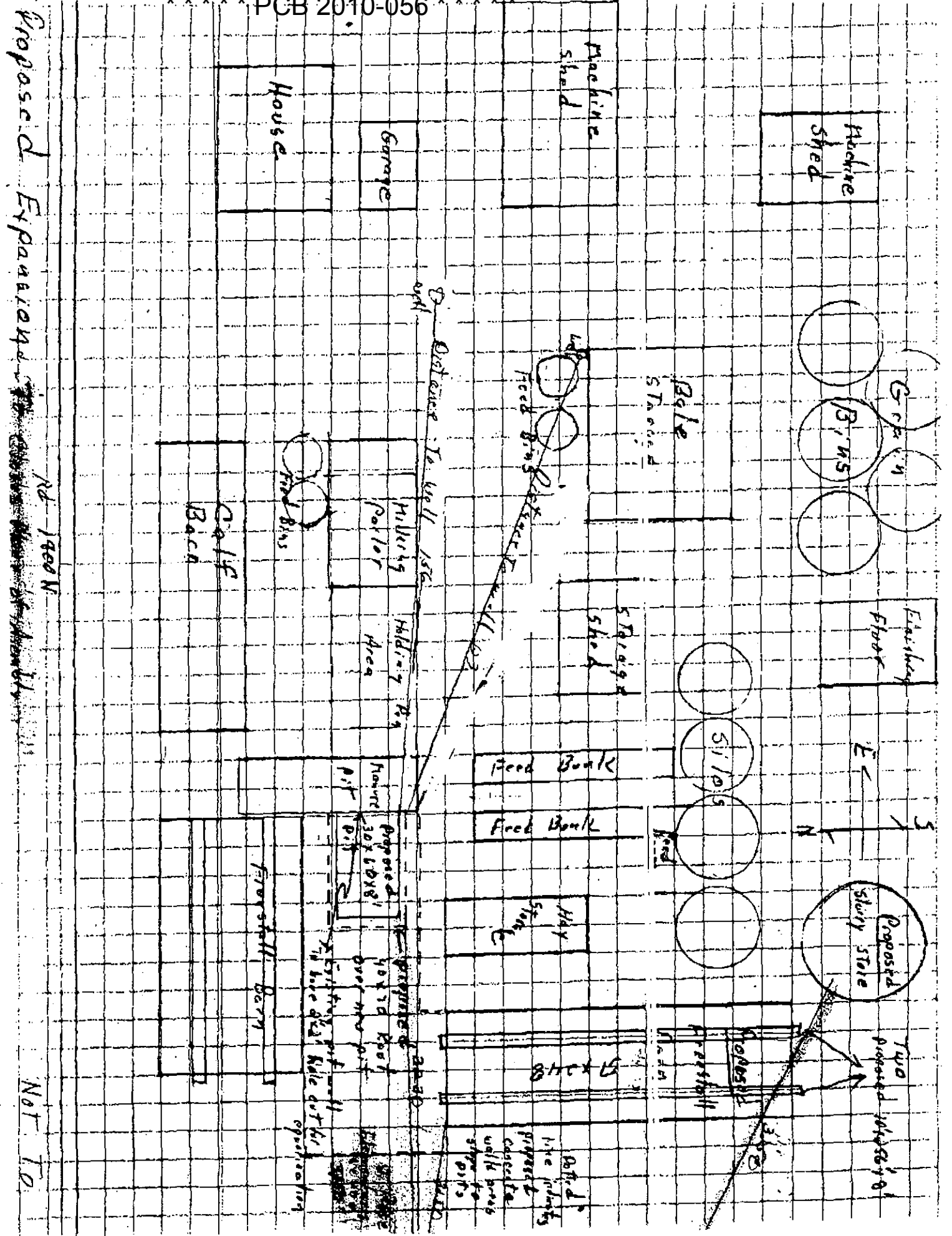

Proposed Expansions in a 1/4 mile

Rd 1400 N

NOT TO

Page No. 2  
Log No. TC-04-03

9. Please indicate if manure drain pull plugs are associated with the manure pits located under the Free Stall Barn and the Cow Lot manure pit. If so, please indicate the number associated with each of the pits.

Please review the subject applications accordingly for the items specified above and submit to the Illinois Environmental Protection Agency by December 15, 2004 so that we may complete the review of the subject application. Please include the above log number on all correspondence.

If you have any questions or comments concerning the above items, please contact me at the above address and telephone number.

Very truly yours,

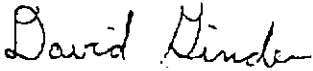

David Ginder  
Environmental Protection Engineer  
Facility Evaluation Unit  
Watershed Management Section  
Bureau of Water

DPG:TC0403rl.doc

cc: T.C. File

123' DIAMETER SLURRYSTORE GIVES 210 DAYS  
STORAGE. SPREADING EVERY SIX MONTHS TO BE  
CONDUCTED IN ACCORDANCE WITH COMPLETE NUTRIENT  
MANAGEMENT PLAN WHICH IS FORMULATED BY AND  
FILED WITH N.R.C.S.

ALL PLANS HAVE BEEN SUBMITTED TO AND COMPLIED  
WITH SPECIFICATIONS OF ILLINOIS DEPT. OF AGRICULTURE.

\*\*\*\*\* PCB 2010-056 \*\*\*\*\*

LANDOWNER

Illinois Environmental Protection Agency  
Bureau of Water

P.O. Box 19276, 021 N. Grand Avenue East  
Springfield, Illinois 62794-9276

**NONPOINT SOURCE POLLUTION CONTROL PROGRAM  
BEST MANAGEMENT PRACTICE APPLICATION FORM**

Project Title: LAKE BRANCH WRAS IMPLEMENTATION

Recipient Name: SOUTHWESTERN IL RC&D, INC.

Grant Number: C9995010-01 Agreement Number: 1190101

File Number: 109 BMP Number: 11

Landowner Name: BUEHNE FARMS INC.

Address: 8606 MAIN STREET

City, State, Zip: ST. ROSE Illinois 62230

Telephone Number: 526-4678 Fax Number: \_\_\_\_\_

Tract Number: T-112 Farm Number: 3821

Receiving Waterbody: LAKE BRANCH

Hydrologic Unit Code: 09 County: CLINTON

Waterbody ID: NE 1/2 OF N 1/2 USGS Map Number: \_\_\_\_\_

Legal Description: NE 1/2 OF N 1/2 89° 41' 30"

Latitude: 38° 32' 30" Longitude: \_\_\_\_\_

NRCS BMP Code: 313 BMP Name: AWMS

Proposed Start Date: 5/04 Proposed Completion Date: 6/04

Attach the following support documentation (or indicate that it is on file in accordance with the provisions of the Financial Assistance Agreement and with approval of the Illinois EPA):

1. A copy of that part of a 7.5 minute USGS topographic map with the site of the best management practice (BMP) identified on it.
- ★ 2. A brief description of the type, purpose, and function of the proposed BMP; the nonpoint source pollutants to be controlled; and characteristics of the site.
3. Plans and specifications for the proposed BMP with sign off by NRCS or registered professional engineer.
4. Landowner Agreement.

This Agency is authorized to require this information under 415 ILCS 5/4(l). Disclosure of this information is required. Failure to do so may prevent this form from being processed and could result in your application being denied. This form has been approved by the Form Management Center.

★ AWMS. THIS FACILITY IS LOCATED APPROXIMATELY 3/4 MILE NORTH EAST OF THE BEGINNING OF LAKE BRANCH. MANURE FROM NEW PROPOSED FACILITY + APPLICATION FIELDS DRAIN INTO LAKE BRANCH. ALL COMPONENTS LISTED ARE NECESSARY TO CONTROL NONPOINT POLLUTION.



FINANCIAL ASSISTANCE AGREEMENT  
LAKE BRANCH  
WRAF IMPLEMENTATION AGREEMENT

THIS CONTRACT, dated this 4 day of MARCH 2004 entered into and between Southwestern Illinois Resource Conservation and Development (hereinafter known as "RC&D") and BUEHNE FARMS INC., the undersigned, as owners and operators (hereinafter known as "Owners") in exchange for mutual benefits and obligations, state and agree as follows:

1. RC&D is the recipient of certain funds from the Illinois Environmental Protection Agency, pursuant to a certain agreement identified as Agreement # 3110101 and as agreement Type 319 (IEPA Agreement).

2. Owner is the owner of certain real estate, commonly known as BUEHNE FARMS INC. 86106 N. STREET ST. (Farm), and legally described on the page attached hereto as Exhibit A, and identified by P.I.N. T-112

3. Pursuant to said IEPA Agreement, the RC&D has agreed to develop a project implementation strategy for the Lake Branch Watershed.

4. In exchange for developing such a program, the RC&D will receive certain moneys designed to be used for cost sharing with participating owners.

5. This Contract is entered into pursuant to said IEPA Agreement, obligating both the RC&D and the Owner to the below identified terms and conditions.

6. The Owner agrees to this Contract, being aware that it is part of the IEPA Agreement, and that the RC&D has certain enforcement duties and obligations.

7. The Owner hereby certifies that Owner is:

- a. the owner of the entire legal interest in the aforementioned farm;
- b. has the legal right and ability to enter into this Contract;
- c. is the operator of the farm.

8. Both the RC&D and the Owner have cooperated to develop an individual waste utilization plan for this farm, attached hereto as Exhibit B.

9. That in exchange for implementing the practices identified in this plan, the RC&D agrees to provide Owner with SEE ATTACHED FORM dollars (\$000.00).

10. Owner agrees to fully cooperate by:

- a. Complying with all construction specifications and requirements as indicated by and agreed to in the Plan, including specific nutrient management plans.
- b. Structure shall be maintained and capable of operation in compliance with the Plan, for the minimum projected lifespan as defined in the USDA NRCS Field Office Technical Guide (FOTG).
- c. Allowing entry on to the farm by representatives of RC&D for the purpose of inspection and supervision during the planning and construction phase, and then at least once annually thereafter for the RC&D to fulfill its monitoring and enforcement obligations to the IEPA.

11. Owners agree that RC&D may file a **Notice of Contract** with the Clinton County Recorder of Deeds, said Notice to be substantially similar in form as is attached as Exhibit C.

12. In the event of a claimed breach of contract, each side must give written notice to the other, and allow 20 days for the other to respond in writing, as to the other's intention to bring the claimed breach into compliance, before any enforcement action is undertaken.

13. In the event that either party to this contract, as a result of a claimed breach of contract, incurs legal costs and attorney fees, then the party determined to be liable to the other party by a Court will also be responsible for all attorney fees and legal costs.

14. In the event that Owner chooses to withdraw from complying with the operating requirements of the Plan, or terminates construction activities once the RC&D has advanced monies for the construction of the Plan requirements, then Owner agrees to pay the RC&D the remaining prorated portion of the cost-share as liquidated damages.

15. In the event of the transfer of said property to a new land owner, it is the current owners responsibility to fully disclose prior to sale and identify the practices that have been implemented as a result of funds provided by the RC&D; and to also clearly identify which practices are required to remain within the agreement period, as well as the remaining length of the agreement period, by practice.

16. This program or activity will be conducted on a non-discriminatory basis without regard to race, color, religion, national origin, age, sex, marital status or disability.

David Gallagher  
Representative of RC&D

3/4/04  
Date

Jeff Buethe  
Owner

3/4/04  
Date



\*\*\*\*\* PCB 2010-056 \*\*\*\*\*

Exhibit C

NOTICE OF CONTRACT  
LAKE BRANCH WRAF IMPLIMENTATION AGREEMENT

Property Address: 8606 MAIN STREET ST. ROSE 62230  
P.I.N.: T-112  
Legal Description:

[Legal description inserted here]

NE 1/2 OF N1/2 SEC. 28 ST. ROSE TWP.  
T 3 N - R 4 W

The below signed owner hereby acknowledges that (s)he has entered into a Contract with Southwestern Illinois Resource Conservation & Development (RC&D), 506 E. Main Street, Mascoutah, Illinois, on the 4 day of MARCH, 2004. Owner has agreed to the creation of certain specific structures, and to implement specific operational practices (to reduce non point source pollution) in exchange for fund from the RC&D. Said contract lasts from the date of the contract through the remaining prorated lifespan of the project, as defined in the USDA NRCS Field Office Technical Guide (FOTG).

[Signature]  
Owner  
Address

This project is limited in scope based upon the funds remaining in the IEPA Lake Branch WRAS Implementation Award. Southwestern Illinois RC&D, Inc. will provide 60% cost-share to the landowner on all approved practices until project funds provided within this award are depleted. However, this project may not exceed the maximum amount identified in the Best Management Practice Application Form without a mutually agreed upon contract modification.

PCB 2010-056

houses

PC

PC/HEL

PCN

120

244  
3605AC

299

92

394.8  
223  
3605AC

PC/NHE

T3519

T146

PC/NHEL

13.8

L134

PC/NHEL

4.0

44.2

2805

138216

2-PC

1339  
415 PC/EC  
135787

T112

PC/NHEL

CS40

207 CE



PCB 2010-056

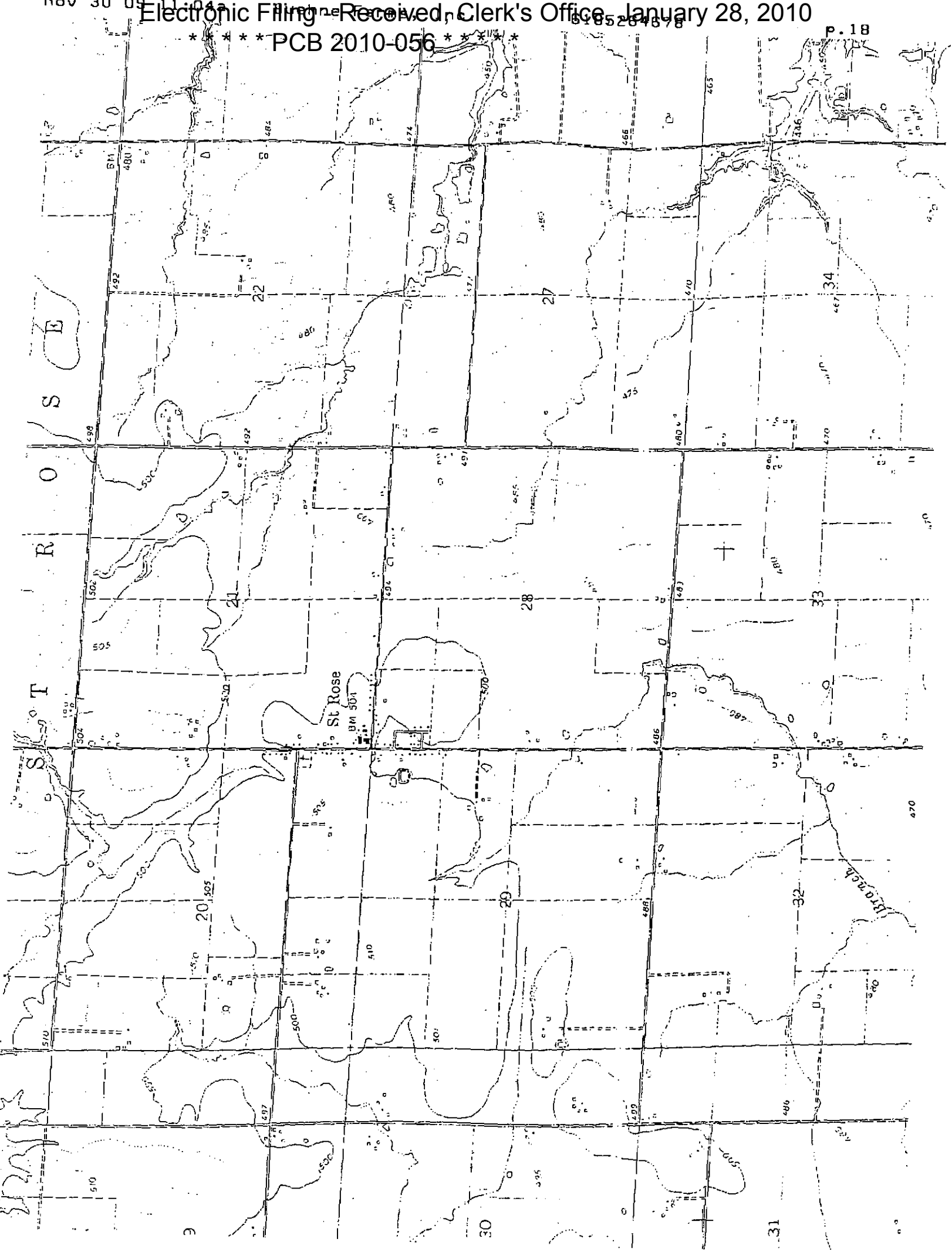

**Buehne Farms, Inc.**

8606 Main Street  
Breese, IL 62230-2526

Phone (618)526-4678  
Fax (618)526-4678

April 26, 2005

Illinois Environmental Protection Agency  
P.O. Box 19276  
Springfield, IL 62794-9276  
Attn: David Ginder

**RECEIVED**  
APR 28 2005  
Watershed Management Section  
BUREAU OF WATER

RE: Illinois Property Tax: Gervase L. Buehne and Norma Buehne  
Trust-St. Rose  
Livestock Waste Management Facilities  
Log No. TC-04-03

Dear David,

Enclosed you will find the paperwork that should take care of what you need per our telephone conversation in April, 2005

If you need anything else feel free to give me a call.

Sincerely,

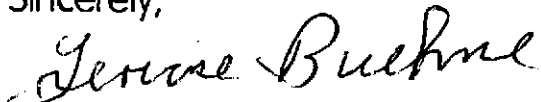

Gervase L. Buehne  
President

DCA Construction, Inc.  
PO Box 38  
Breese, IL 62230  
618-526-8300

April 15, 2005

Buehne Farms

Cost of pits in 46' x 152' freestall barn with slatted floor.

\$82,500.00

200 LF 6" x 6" curb.

\$2,000.00

Cost of 16 x 60 x 8' pit with concrete lid.

\$28,500.00

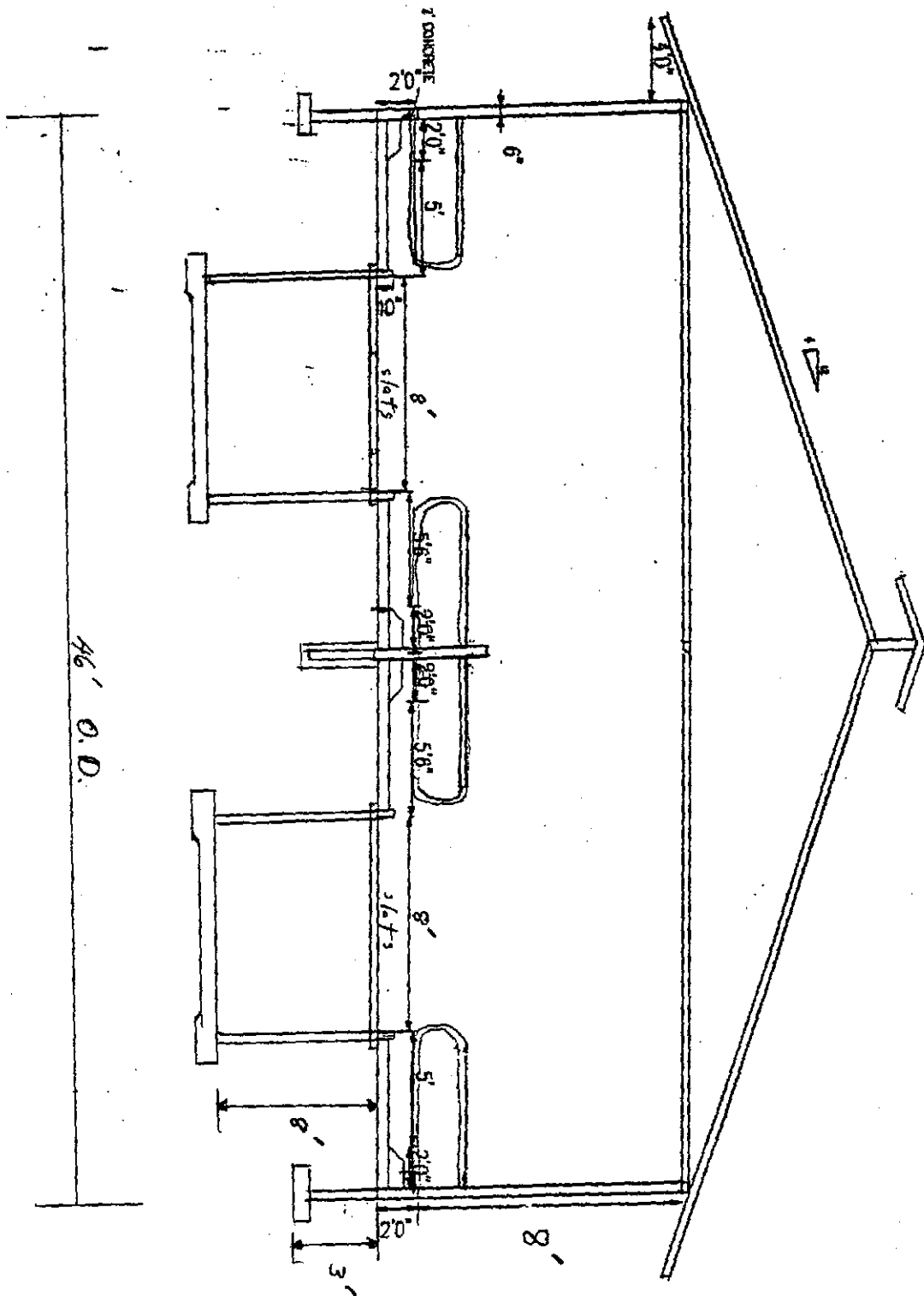





**Buehne Farms, Inc**

8606 Main Street  
Breese, IL 62230-2526

Phone (618)526-4678  
Fax (618)526-4678

January 8, 2005

**RECEIVED**

JAN 18 2005

**Watershed Management Section  
BUREAU OF WATER**

Illinois Environmental Protection Agency  
P.O. Box 19276  
Springfield, IL 62794-9276

RE: Log No. TC-04-03

Illinois Property Tax: Gervase L. Buehne, Gervase L. and Norma Buehne Trust

To Whom It May Concern:

Below you will find the answers from the letter you sent us in regard to the application for Illinois Property Tax Certification received March 17, 2003.

1. Please Provide the location by section, township and range in numeric form for the property where the livestock facilities are located.

**Sec 28 Twp 3<sup>N</sup> Rng 4 W ½ NE**

2. Please provide the date when construction was completed for the livestock waste management structures for which property tax certification is sought.

**Completed 10-31-01**

3. Please provide the fair cash value of the livestock waste management facilities for which property tax certification is sought as requested by item in Section E of the application form.

**S.S., pump, piping, values**

- a. \$195,146
- b. \$20,000
- c. used for storage only
- d. used for storage only
- e. 70-80%

4. Please include complete dimensions and the materials of construction for the manure pits and slotted floor located over the manure pits Free Stall Barn.

**Slotted Floor Pits**

**New Buildings (2) pits 10'X10'X248' built per Midwest Farm Plan Specs  
See Attached**

01/28/2010 10:00:00 AM

\*\*\*\*\* PCB 2010-056 \*\*\*\*\*

\*\*\*\*\* PCB 2010-056 \*\*\*\*\*

\*\*\*\*\* PCB 2010-056 \*\*\*\*\*

\*\*\*\*\* PCB 2010-056 \*\*\*\*\*

\*\*\*\*\* PCB 2010-056 \*\*\*\*\*

\*\*\*\*\* PCB 2010-056 \*\*\*\*\*

\*\*\*\*\* PCB 2010-056 \*\*\*\*\*

\*\*\*\*\* PCB 2010-056 \*\*\*\*\*

\*\*\*\*\* PCB 2010-056 \*\*\*\*\*

\*\*\*\*\* PCB 2010-056 \*\*\*\*\*

\*\*\*\*\* PCB 2010-056 \*\*\*\*\*

\*\*\*\*\* PCB 2010-056 \*\*\*\*\*

\*\*\*\*\* PCB 2010-056 \*\*\*\*\*

\*\*\*\*\* PCB 2010-056 \*\*\*\*\*

\*\*\*\*\* PCB 2010-056 \*\*\*\*\*

\*\*\*\*\* PCB 2010-056 \*\*\*\*\*

\*\*\*\*\* PCB 2010-056 \*\*\*\*\*

5. Please indicate if the manure holding tank has a reinforced Portland Cement Concrete base.

**See Attached**

6. Please indicate if certification is sought for the manure pit associated with the Cow Lot. If so, please indicate the dimensions and materials of construction of the manure pit. Please indicate if slotted flooring exists over the Cow Lot manure pit and specify the material of construction for such slotted flooring. Please indicate how manure enters the Cow Lot pit.

**Slotted Floor Pits, gravity**

**See Attached**

7. Please indicate the total length, diameter and material of construction of the manure transfer piping associated with the pits located under the Free Stall Barn, the manure holding tank and the Cow Lot pit.

**700' 6" PVC sch 40 pipe**

**(5) 6" MJ valmatic plug valve see attached**

8. Please indicate if any manure transfer pumps are associated with the manure holding tank, the manure pits located under the Free Stall Barn and the Cow Lot manure pit. If so, please indicate if the pumps are engine driven, electrically driven or pto-driven.

**PTO driven pumps**

9. Please indicate if manure drain pull plugs are associated with the manure pits located under the Free Stall Barn and the Cow Lot manure pit. If so, please indicate the number associated with each of the pits.

**(3) valves used in item (7) highlights in yellow**

If you have any question or comments concerning the above items, please contact me at the above address and telephone number.

Sincerely,

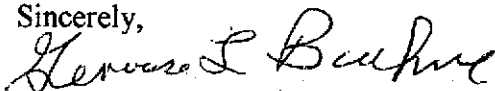

Gervase L. Buehne  
President

\*\*\*\*\* PCB 2010-056 \*\*\*\*\*

[Faint, illegible text]

[Faint, illegible text]

[Faint, illegible text]

[Faint, illegible text]

[Faint, illegible text]

[Faint, illegible text]

[Faint, illegible text]



\*\*\*\*\*  
**DEA CONSTRUCTION, INC.**  
\*\*\*\*\*

Donald Albers, President  
PO Box 38, 1620 North Fourth St.  
Breese, IL 62230  
618-526-8300 618-526-2782 - fax

Gervase L. Buehne  
Gervase L. & Norma Buehne Trust  
8606 Main Street  
St. Rose, IL 62230

January 6, 2005

#4 - All dimension and materials for the pits referred to in question #4 are on the attached drawings and literature.

Cash value for pits and floors \$122,109.00

#6 - All dimension and materials for the cow lot pit referred to in question #6 are included on the attached drawing and literature. Floor is slatted.

Cash value \$34,004.00

**DESIGN CRITERIA:**  
 ASTM A615 GRADE 60 REINFORCING STEEL  
 7000 PSI CONCRETE 28 DAY COMPRESSIVE STRENGTH  
 SEE IIW PERM #91820 FOR DESIGN LOADS

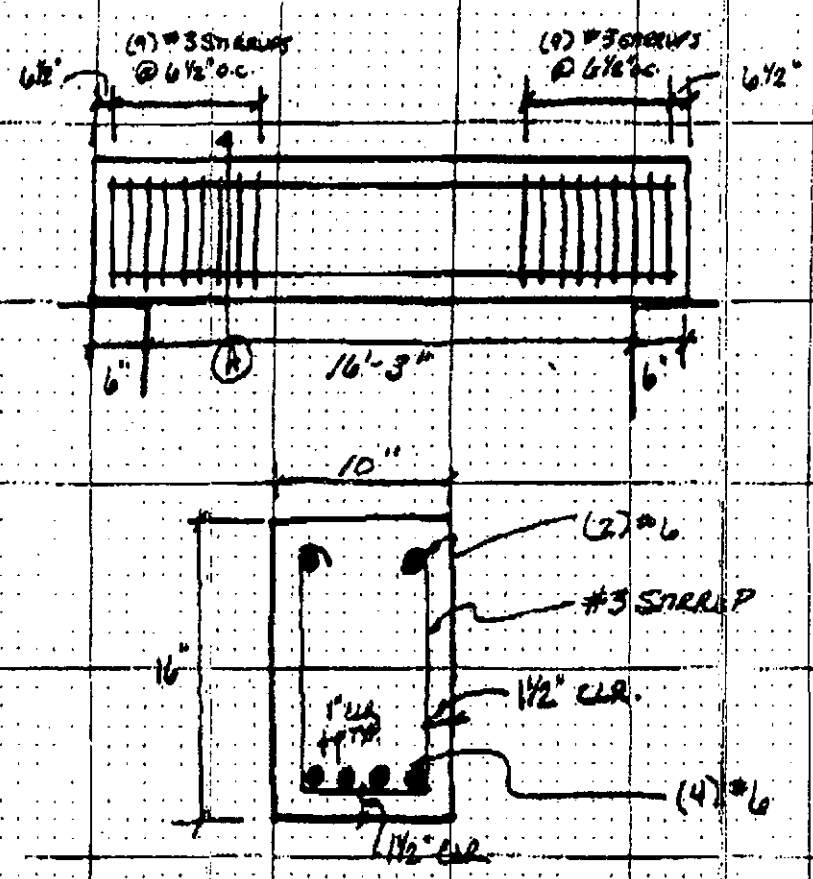

<b>IIW Engineers &amp; Surveyors, P.C.</b>				
	COMPUTED BY	CHECKED BY	DATE	REVISION OF #91820 <b>CATTLE SLAB BEAM</b>
	PROJECT TITLE	PROJECT NO.		
			2/2/2000	MSBM
				TOTAL P. 02

## CONCRETE WORK

Item 5

Concrete work shall conform to the requirements of ACI 301-99, Specifications for Structural Concrete, except as modified by the supplemental requirements noted below.

1. Concrete shall attain an ultimate 28 day compressive strength of 4000 PSI ( 27579 KPa).
2. Reinforcing bars shall conform to ASTM A615, grade 60. Welding of bars is not permitted. Field bending of partially embedded reinforcing bars shall conform to Section 3.3.2.8.
3. Cement shall conform to ASTM C150, Type I or Type II with air entraining admixture per ASTM C260 added at the mixer to achieve 4-6% by volume of entrained air at the point of concrete placement.
4. Maximum aggregate size shall be 1 1/2" (38 mm). Fine and coarse aggregate shall conform to ASTM C33 with the restrictions on reactive materials specified in paragraphs 7.3 and 11.2 applying.
5. Ready mixed concrete shall conform to ASTM C94, Option A. The supplier shall be responsible for determining the proportions used in the concrete mix.
6. Earth cuts may be used as formwork for footings only, provided the footing depth does not exceed 48" (1219 mm).
7. Finished surfaces
  - A. Rough form finish is acceptable for vertical surfaces.
  - B. Floated finish is required for the floor surface.
8. The following sections of ACI 301-99 do not apply:
  - 6 - Architectural Concrete
  - 7 - Lightweight Concrete
  - 8 - Mass Concrete
  - 9 - Prestressed Concrete
  - 10 - Shrinkage-compensating Concrete



THESE MATERIALS ARE TO BE FURNISHED BY THE BUILDER. QUANTITIES ARE ESTIMATED.

THE TOTAL REBAR REQUIREMENTS MUST BE CALCULATED AND WILL DEPEND UPON THE NUMBER OF SPLICES.

CHANGING THE FLOOR OR FOOTING DESIGN, FROM WHAT IS CALLED OUT IN THIS SUBMITTAL, MAY AFFECT THE REBAR AND SPLICE REQUIREMENTS.

#### FOOTING MATERIAL REQUIREMENTS

##### CIRCUMFERENTIAL FOOTING REBAR-

1. QTY. REBAR:	10	
2. SIZE OF REBAR:	# 5 ( 1.043 lbs/ft)	
3. TOTAL REBAR QTY. WITHOUT SPLICE:	3880 ft.	1182582 mm
4. SPLICE LENGTH:	35 in.	0 mm

##### FOOTING TIE BARS-

1. QTY. OF REBARS (PER SHEET):	4	
2. SIZE OF REBAR:	# 4 ( .668 lbs/ft)	
3. TOTAL REBAR QTY.:	616 ft.	187751 mm

##### CONCRETE IN FOOTING-

1. PER 1 " DEPTH (25.4 mm)	1.5 cu. yds.	1.1 m3
----------------------------	--------------	--------

##### GRAVEL-

1. PER 3. " DEPTH ( 76.2 mm)	108.9 cu. yds.	83.2 m3
------------------------------	----------------	---------

THESE MATERIALS ARE TO BE FURNISHED BY THE BUILDER. QUANTITIES ARE ESTIMATED.

THE TOTAL REBAR REQUIREMENTS MUST BE CALCULATED AND WILL DEPEND UPON THE NUMBER OF SPLICES.

CHANGING THE FLOOR OR FOOTING DESIGN, FROM WHAT IS CALLED OUT IN THIS SUBMITTAL, WILL AFFECT THE REBAR AND SPLICE REQUIREMENTS.

#### FLOOR MATERIAL REQUIREMENTS

##### CIRCUMFERENTIAL REBAR IN FLOOR-

- |                                     |                    |           |
|-------------------------------------|--------------------|-----------|
| 1. SIZE OF REBAR:                   | # 4 ( .668 lbs/ft) |           |
| 2. TOTAL REBAR QTY. WITHOUT SPLICE: | 774 ft.            | 235807 mm |
| 3. SPLICE LENGTH:                   | 22 in.             | 559 mm    |

##### CURB CIRCUMFERENTIAL REBAR IN FLOOR-

- |                                     |                     |           |
|-------------------------------------|---------------------|-----------|
| 1. SIZE OF REBAR:                   | #10 ( 4.303 lbs/ft) |           |
| 2. TOTAL REBAR QTY. WITHOUT SPLICE: | 389 ft.             | 118567 mm |
| 3. SPLICE LENGTH:                   | 145 in.             | 3683 mm   |

##### FLOOR REBAR-

- |                                     |                    |            |
|-------------------------------------|--------------------|------------|
| 1. SIZE OF REBAR:                   | # 3 ( .376 lbs/ft) |            |
| 2. ON CENTER BOTH WAYS DIM.:        | 12.0 in.           | 304.8 mm   |
| 3. TOTAL REBAR QTY. WITHOUT SPLICE: | 23815 ft.          | 7258686 mm |
| 4. SPLICE LENGTH:                   | 16 in.             | 406 mm     |

##### CONCRETE IN FLOOR-

- |                              |                |          |
|------------------------------|----------------|----------|
| 1. PER 5. " DEPTH (127.0 mm) | 197.0 cu. yds. | 150.6 m3 |
|------------------------------|----------------|----------|

*Item 5. reinforced portland Cement Concrete base*

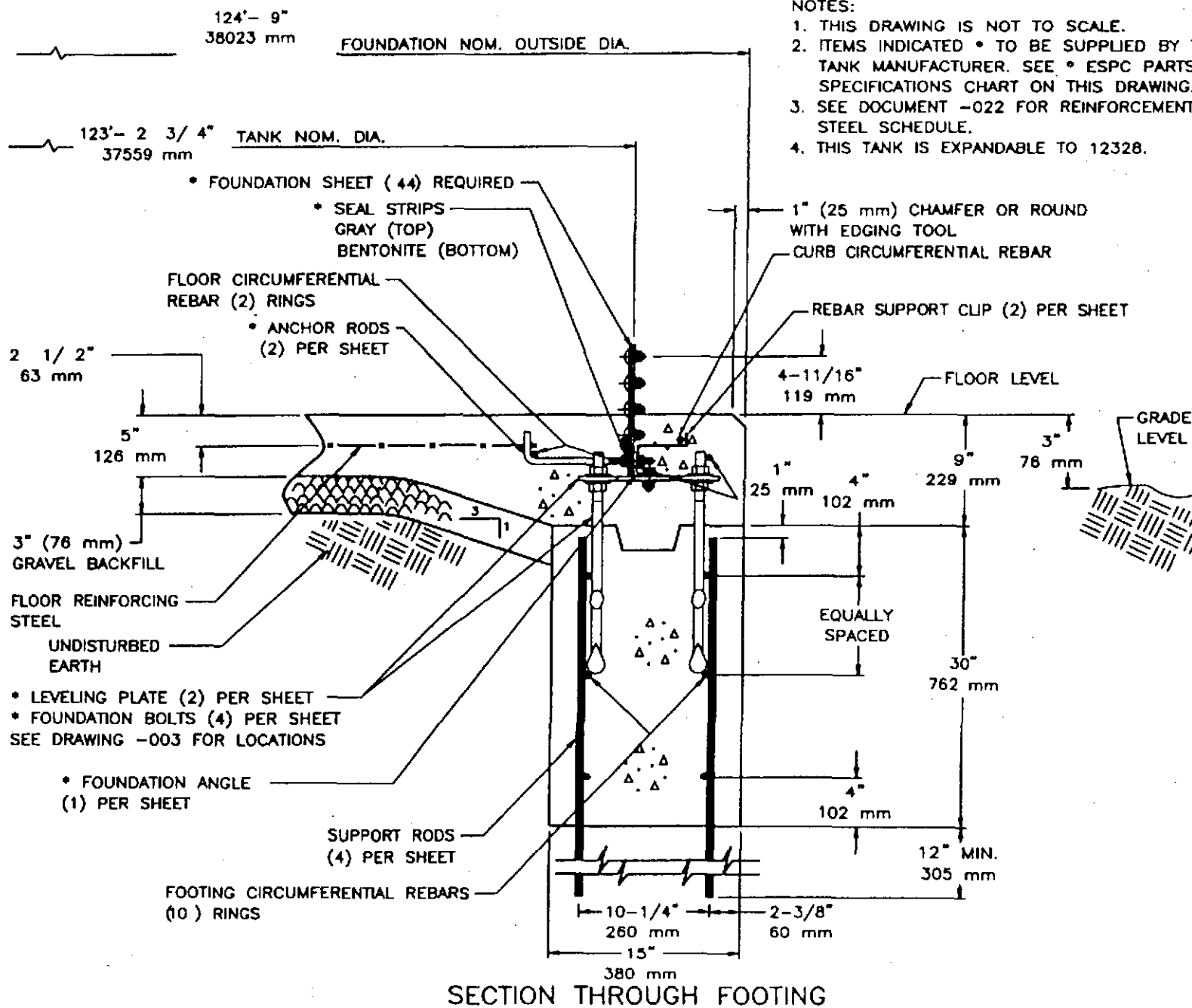

REL	DESCRIPTION
1	REL PER MFP 5015011 04/25/01
* ESPC PARTS SPECIFICATIONS	
ANCHOR RODS	IN. 1/2 DIA mm 13 DIA
FOUNDATION ANGLES	IN. 2 X 2 X 1/4 mm 51 X 51 X 6
LEVELING PLATES	IN. 3/8 X 3-1/2 X 11 mm 10 X 89 X 279
FOUNDATION BOLTS	IN. 3/4 DIA X 18 LG. mm 19 DIA X 457 LG.
<b>ENGINEERED STORAGE PRODUCTS COMPANY</b> DEKALB, ILLINOIS 60118 <b>CONFIDENTIAL</b> THIS DRAWING IS THE PROPRIETARY PROPERTY OF ENGINEERED STORAGE PRODUCTS COMPANY AND SHALL NOT BE USED NOR REPRODUCED WITHOUT THE EXPRESS WRITTEN CONSENT OF THE COMPANY. ESPC COPYRIGHT © 2001 ALL RIGHTS RESERVED	
FILE:	50150118
DRAWN BY	DMA
DATE	04/25/01
<b>123' SLURRYSTORE FND</b> SZ 0 <b>BUEHNE FARMS INC.</b> BREESE, IL	
DRWG NO.	5015011-002

SECTION THROUGH FOOTING

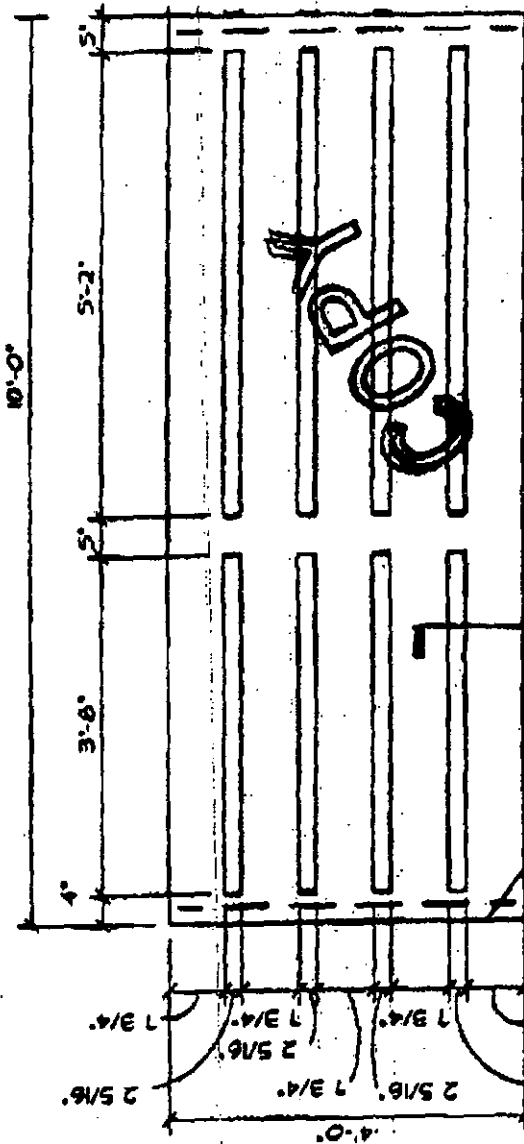

(1) #6 BOT. 1" CLR. IN-  
LONGITUDINAL RIBS TYP. (

(1) #6 BOT. 1 1/4" CLR. IN  
TRANSVERSE RIBS TYP. OF 4

TYP. RIB  
SECTION



4" MIN. BEARING . TYP.

PRECAST GANG SLATS

SCALE: 1/2" = 1'-0"



(1) #6 BOT. 1" CLR.  
LONGITUDINAL TYP. OF 5

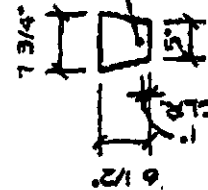

SECTION

PRECAST CATTLE SLAT  
7000 PSI Concrete compression 28 days  
Grade 60 Rebar



ENGINEERS AND  
SURVEYORS P.C.

4155 PENNSYLVANIA AVE. DUBUQUE, IA

52002 (319) 556-2464  
FAX (319) 556-7811

TOTAL

**DISTRIBUTION GROUP**

USF - Granite City IL  
 Branch - 420  
 45 Northgate Industrial Drive  
 Granite City IL 62040  
 618/452-3353

Remit to:  
**US FILTER DISTRIBUTION GROUP**  
 PO BOX 503660  
 ST. LOUIS, MO 63150-3660

**INVOICE**

*5 items*

*Item 7*

<b>Total Amount Due</b>
<b>2,712.46</b>

**KOHLBRECHER EQUIPMENT, INC.**  
 21429 SAINT ROSE RD  
 HIGHLAND IL 62249-

Shipped to:  
 1/2 MI EAST OF ST ROSE SCHOOL  
 99/067 TO FARM ON RIGHT SIDE NEAR  
 BLUE SILOS  
 ST ROSE, IL

**Return Top Portion With Payment For Faster Credit**

*Thank You For The Opportunity To Serve You.  
 We appreciate your prompt payment.*

Date Ordered	Date Shipped	Customer PO No.	Job Name	Job No.	Bill of Lading	Shipped Via	Order Number
6/20/01	6/29/01	JK	BUEHNE FARM			OUR TRUCK	7494640

Product Code	Description	Quantity Ordered	Quantity Shipped	Back-Ordered	Price	Per	Amount
/10002288064	✓ 6 MJ PLUG VALVE, 2 NUT (5906RN) BID SEQ# 60	2	2		509.38000	EA	1,018.76
0506040	✓ 6 PVC SCH40 PIPE SWB 20' BID SEQ# 210	220	220		2.53000	FT	556.60
21I06T060M	✓ 6X6 MJ TEE (I) CP DI C153 BID SEQ# 230	1	1		93.50000	EA	93.50
29060409HH	✓ 6 PVC SCH40 90 BEND HXH BID SEQ# 310	1	1		31.54000	EA	31.54
29060404HH	✓ 6 PVC SCH40 45 BEND HXH BID SEQ# 360	4	4		31.92000	EA	127.68
21I06W060M	✓ 6X6 MJ WYE (I) CP DI C153 BID SEQ# 380	3	3		178.50000	EA	535.50
21AMMJT06	✓ 6" MJ TRANSITION ACC SET BID SEQ# 390	16	16		15.48000	EA	247.68
040640DWVPE10	✓ 6 SCH40/DWV PVC PE PIPE 10'	40	40		2.53000	FT	101.20

*0.10 4430  
557  
Buehne Farm*

Terms	Subtotal
NET 30	2,712.46

Freight	Delivery	Handling	Restock	Misc	Tax	Invoice Total
						2,712.46

\*\*\*\*\* THANK YOU FOR YOUR ORDER \*\*\*\*\*  
 BY REQUEST, USF PO# TO MATCH VENDOR PACKING SLIPS IS  
 NOW ON THE FIRST LINE OF DIRECT INVOICES.  
 GRANITE CITY HOUSE 618/452-3353

Please pay this amount 

USF - Granite City IL  
 Branch - 420  
 45 Northgate Industrial Drive  
 Granite City IL 62040

**VIVENDI**  
 water company

**DISTRIBUTION GROUP**

USF - Lebanon IL  
 Branch - 240  
 107 Southern Street  
 Lebanon IL 62254

618/537-2330

Remit to:  
 US FILTER DISTRIBUTION GROUP  
 PO BOX 503660  
 ST. LOUIS, MO 63150-3660

**INVOICE**

KOHLBRECHER EQUIPMENT, INC.  
 21429 SAINT ROSE RD  
 HIGHLAND IL 62249-

Shipped to:  
 1/2 mi east of st rose school  
 99/028 to farm on right near blue sil  
 os - buehne farms  
 HIGHLAND, IL

<b>Total Amount Due</b>
<b>591.81</b>

**Return Top Portion With Payment For Faster Credit**

*Thank You For The Opportunity To Serve You.  
 We appreciate your prompt payment.*

Date Ordered	Date Shipped	Customer PO No.	Job Name	Job No.	Bill of Lading	Shipped Via	Order Number
7/02/01	7/02/01	JK	BUHNE FARMS			OUR TRUCK	7528587

Product Code	Description	Quantity Ordered	Quantity Shipped	Back-Ordered	Price	Per	Amount
0506040	✓ 6 PVC SCH40 PIPE SWB 20'	200	200		2.53000	FT	506.00
29060409HH	✓ 6 PVC SCH40 90 BEND HXH	2	2		31.54350	EA	63.09
29APGQ	✓ CLEAR PVC CEMENT / QUART	2	2		7.12000	EA	14.24
29APCQ	✓ CLEANER- PVC - QUART	2	2		4.24000	EA	8.48

*Handwritten notes:*  
 9/12  
 550-4430  
 [Signature]

						Terms	Subtotal
						NET 30	591.81
Freight	Delivery	Handling	Restock	Misc	Tax	Invoice Total	
						591.81	

\*\*\*\*\* THANK YOU FOR YOUR ORDER \*\*\*\*\*  
 BY REQUEST, USF PO# TO MATCH VENDOR PACKING SLIPS IS  
 NOW ON THE FIRST LINE OF DIRECT INVOICES.  
 GRANITE CITY HOUSE 618/537-2330

Please pay this amount 

USF - Lebanon IL  
 Branch - 240  
 107 Southern Street  
 Lebanon IL 62254



**DISTRIBUTION GROUP**

USF - Granite City IL  
 Branch - 420  
 45 Northgate Industrial Drive  
 Granite City IL 62040  
 618/452-3353

Remit to:  
 US FILTER DISTRIBUTION GROUP  
 PO BOX 503660  
 ST. LOUIS, MO  
 63150-3660

**INVOICE**

<b>Total Amount Due</b>
<b>1,179.06</b>

Shipped to:  
 buehne farms  
 99/027 turn next to st rose school  
 st rose, IL

KOHLBRECHER EQUIPMENT, INC.  
 21429 SAINT ROSE RD  
 HIGHLAND IL 62249-

**Return Top Portion With Payment For Faster Credit**

*Thank You For The Opportunity To Serve You.  
 We appreciate your prompt payment.*

Date Ordered	Date Shipped	Customer PO No.	Job Name	Job No.	Bill of Lading	Shipped Via	Order Number
7/17/01	7/20/01	JOHN	BUEHNE FARM			OUR TRUCK	7572677

Product Code	Description	Quantity Ordered	Quantity Shipped	Back-Ordered	Price	Per	Amount
5706M5908N	✓ 6 MJ VALMATIC PLUG VALVE	1	1		509.38000	EA	509.38
21AMMJT06	✓ 6" MJ TRANSITION ACC SET	4	4		14.90000	EA	59.60
5706M118E	✓ 6 MJ FIG 118 PLUG VLV EPOXY 1/4 TURN 2" NUT	1	1		509.38000	EA	509.38
59CB2194LOS	✓ CB 2194 LID ONLY "SEWER" MS4912S	5	5		7.19000	EA	35.95
59CB2194F	✓ CB 2194 FRAME ONLY MS4912	5	5		12.95000	EA	64.75

*9/10  
550-4436*

						Terms	Subtotal
						NET 30	1,179.06
Freight	Delivery	Handling	Restock	Misc	Tax	Invoice Total	
						1,179.06	

\*\*\*\*\* THANK YOU FOR YOUR ORDER \*\*\*\*\*  
 BY REQUEST, USF PO# TO MATCH VENDOR PACKING SLIPS IS  
 NOW ON THE FIRST LINE OF DIRECT INVOICES.  
 GRANITE CITY HOUSE 618/452-3353

Please pay this amount 

USF - Granite City IL  
 Branch - 420  
 45 Northgate Industrial Drive  
 Granite City IL 62040



**DISTRIBUTION GROUP**

USF - Lebanon IL  
 Branch - 240  
 107 Southern Street  
 Lebanon IL 62254  
 618/537-2330

Remit to:  
 US FILTER DISTRIBUTION GROUP  
 PO BOX 503660  
 ST. LOUIS, MO  
 63150-3660

**INVOICE**

KOHLBRECHER EQUIPMENT, INC.  
 21429 SAINT ROSE RD  
 HIGHLAND IL 62249-

Shipped to:  
 JOBSITE AT BUEHNE FARMS  
 99/036 EAST OF ST ROSE SCHOOL  
 ST ROSE, IL

<b>Total Amount Due</b>
<b>509.38</b>

**Return Top Portion With Payment For Faster Credit**

*Thank You For The Opportunity To Serve You.  
 We appreciate your prompt payment.*

Date Ordered	Date Shipped	Customer PO No.	Job Name	Job No.	Bill of Lading	Shipped Via	Order Number
7/05/01	7/19/01	JK	BUEHNE FARM			OUR TRUCK	7537137

Product Code	Description	Quantity Ordered	Quantity Shipped	Back-Ordered	Price	Per	Amount
/10002310957	✓ 6 MJ PLUG VALVE, 2 NUT (5906RN)	1	1		509.38000	EA	509.38
21AMMJT06	✓ 6" MJ TRANSITION ACC SET	2	2		N/C	EA	

*9/10  
 550-4430  
 Buehne*

						Terms	Subtotal
						NET 30	509.38
Freight	Delivery	Handling	Restock	Misc	Tax	Invoice Total	
						509.38	

\*\*\*\*\* THANK YOU FOR YOUR ORDER \*\*\*\*\*  
 BY REQUEST, USF PO# TO MATCH VENDOR PACKING SLIPS IS  
 NOW ON THE FIRST LINE OF DIRECT INVOICES.  
 GRANITE CITY HOUSE 618/537-2330

Please pay this amount 

USF - Lebanon IL  
 Branch - 240  
 107 Southern Street  
 Lebanon IL 62254





**DISTRIBUTION GROUP**

USF - Granite City IL  
 Branch - 420  
 45 Northgate Industrial Drive  
 Granite City IL 62040  
 618/452-3353

Remit to:  
 US FILTER DISTRIBUTION GROUP  
 PO BOX 503660  
 ST. LOUIS, MO 63150-3660

**INVOICE**

KOHLBRECHER EQUIPMENT, INC.  
 21429 SAINT ROSE RD  
 HIGHLAND IL 62249-

Shipped to:  
 CUSTOMER PICK-UP  
 99/030

<b>Total Amount Due</b>
95.75

**Return Top Portion With Payment For Faster Credit**

*Thank You For The Opportunity To Serve You.  
 We appreciate your prompt payment.*

Date Ordered	Date Shipped	Customer PO No.	Job Name	Job No.	Bill of Lading	Shipped Via	Order Number
7/23/01	7/24/01	SHOP	SHOP			PICK UP	7592899

Product Code	Description	Quantity Ordered	Quantity Shipped	Back-Ordered	Price	Per	Amount
29060404HH	✓ 6 PVC SCH40 45 BEND HXH	3	3		31.91750	EA	95.75

*file 4430  
 550  
 Bunker*

						Terms	Subtotal
						NET 30	95.75
Freight	Delivery	Handling	Restock	Misc	Tax	Invoice Total	
						95.75	

\*\*\*\*\* THANK YOU FOR YOUR ORDER \*\*\*\*\*  
 BY REQUEST, USF PO# TO MATCH VENDOR PACKING SLIPS IS  
 NOW ON THE FIRST LINE OF DIRECT INVOICES.  
 GRANITE CITY HOUSE 618/452-3353

Please pay this amount 

USF - Granite City IL  
 Branch - 420  
 45 Northgate Industrial Drive  
 Granite City IL 62040



**DISTRIBUTION GROUP**

USF - Lebanon IL  
 Branch - 240  
 107 Southern Street  
 Lebanon IL 62254  
 618/537-2330

Remit to:  
 US FILTER DISTRIBUTION GROUP  
 PO BOX 503660  
 ST. LOUIS, MO  
 63150-3660

**INVOICE**

KOHLBRECHER EQUIPMENT, INC.  
 21429 SAINT ROSE RD  
 HIGHLAND IL 62249-

Shipped to:  
 BUEHNE FARMS - 1/2 MILE EAST  
 99/041 OF ST ROSE SCHOOL ON RIGHT SID  
 E OF RD - BLUE SILOS  
 ST ROSE, IL

<b>Total Amount Due</b>
<b>904.41</b>

**Return Top Portion With Payment For Faster Credit**

*Thank You For The Opportunity To Serve You.  
 We appreciate your prompt payment.*

Date Ordered	Date Shipped	Customer PO No.	Job Name	Job No.	Bill of Lading	Shipped Via	Order Number
6/20/01	6/21/01	JK	BUEHNE FARM			OUR TRUCK	7494694

Product Code	Description	Quantity Ordered	Quantity Shipped	Back-Ordered	Price	Per	Amount
0506040	6 PVC SCH40 PIPE SWB 20' BID SEQ# 210	300	300		2.53000	FT	759.00
29060409HH	6 PVC SCH40 90 BEND HXH BID SEQ# 310	2	2		31.54350	EA	63.09
29060404HH	6 PVC SCH40 45 BEND HXH BID SEQ# 360	2	2		31.91750	EA	63.84
29APCQ	CLEANER- PVC - QUART	1	1		4.24000	EA	4.24
29APGQ	CLEAR PVC CEMENT / QUART	2	2		7.12000	EA	14.24

*520-4430  
 12/25/05  
 [Signature]*

						Terms	Subtotal
						NET 30	904.41
Freight	Delivery	Handling	Restock	Misc	Tax	Invoice Total	
						904.41	

\*\*\*\*\* THANK YOU FOR YOUR ORDER \*\*\*\*\*  
 BY REQUEST, USF PO# TO MATCH VENDOR PACKING SLIPS IS  
 NOW ON THE FIRST LINE OF DIRECT INVOICES.  
 GRANITE CITY HOUSE 618/537-2330

Please pay this amount 

USF - Lebanon IL  
 Branch - 240  
 107 Southern Street  
 Lebanon IL 62254







ILLINOIS ENVIRONMENTAL PROTECTION AGENCY

1021 NORTH GRAND AVENUE EAST, P.O. BOX 19276, SPRINGFIELD, ILLINOIS 62794-9276, 217-782-3397

JAMES R. THOMPSON CENTER, 100 WEST RANDOLPH, SUITE 11-300, CHICAGO, IL 60601, 312-814-6026

217/782-3362

ROD R. BLAGOJEVICH, GOVERNOR

RENEE CIPRIANO, DIRECTOR

November 17, 2004

Gervase L. Buehne  
Gervase L. and Norma Buehne Trust  
8,606 Main Street  
St. Rose, Illinois 62230

Re: Illinois Property Tax: Gervase L. and Norma Buehne Trust - St. Rose  
Livestock Waste Management Facilities  
Log No. TC-04-03

Gentlemen:

The application for Illinois Property Tax Certification received March 17, 2003 for the above listed facilities has been reviewed and the following is offered for your consideration and appropriate action.

1. Please provide the location by section, township and range in numeric form (i.e., Section 2, T23N, R6E) for the property where the livestock facilities are located.
2. Please provide the date when construction was completed for the livestock waste management structures for which property tax certification is sought.
3. Please provide the fair cash value of the livestock waste management facilities for which property tax certification is sought as requested by item (5) in Section E of the application form.
4. Please include complete dimensions (length, width, depth, diameter, etc.) and the materials of construction (concrete, steel, plastic, PVC, etc.) for the manure pits and slotted floor located over the manure pits in the Free Stall Barn.
5. Please indicate if the manure holding tank (123 ft. in diameter and 19 ft. in height) has a reinforced Portland Cement Concrete base.
6. Please indicate if certification is sought for the manure pit associated with the Cow Lot. If so, please indicate the dimensions and materials of construction of the manure pit. Please indicate if slotted flooring exists over the Cow Lot manure pit and specify the material of construction for such slotted flooring. Please indicate how manure enters the Cow Lot pit (i.e., scraped, through slotted flooring, gravity, etc.)
7. Please indicate the total length, diameter and material of construction of the manure transfer piping associated with the pits located under the Free Stall Barn, the manure holding tank (123 ft. in diameter and 19 ft. in height) and the Cow Lot pit.
8. Please indicate if any manure transfer pumps are associated with the manure holding tank, the manure pits located under the Free Stall Barn and the Cow Lot manure pit. If so, please indicate if the pumps are engine driven, electrically driven or pto-driven.

9. Please indicate if manure drain pull plugs are associated with the manure pits located under the Free Stall Barn and the Cow Lot manure pit. If so, please indicate the number associated with each of the pits.

Please review the subject applications accordingly for the items specified above and submit to the Illinois Environmental Protection Agency by December 15, 2004 so that we may complete the review of the subject application. Please include the above log number on all correspondence.

If you have any questions or comments concerning the above items, please contact me at the above address and telephone number.

Very truly yours,



David Ginder  
Environmental Protection Engineer  
Facility Evaluation Unit  
Watershed Management Section  
Bureau of Water

DPG:TC0403rl.doc

cc: T.C. File

**RECEIVED**

\* PCB 2010-056 \* \* \* \* \*

ILLINOIS ENVIRONMENTAL PROTECTION AGENCY

POLLUTION CONTROL FACILITY

AIR  WATER

MAR 17 2003 gm

ILLINOIS ENVIRONMENTAL PROTECTION AGENCY  
 P.O. Box 19276, Springfield, IL 62794-9276  
 BOWWPC/PERMIT SECTION

This Agency is authorized to request this information under Illinois Revised Statutes, 1979, Chapter, 120, Section 502a-5. Disclosure of this information is voluntary. However, failure to comply could prevent your application from being processed or could result in denial of your application for certification.

FOR AGENCY USE

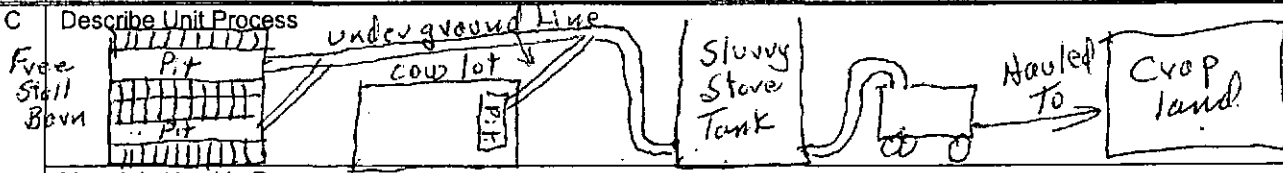
File No.	Date Received	Certification No.	Date <u>3/</u>
Sec. A  APPLICANT	Company Name <u>Buehne, Gervase L &amp; Norma Trust</u>		
	Person Authorized to Receive Certification <u>Gervase Buehne</u>		Person to Contact for Additional Details <u>Same</u>
	Street Address <u>8606 Main St.</u>		Street Address <u>Same</u>
	Municipality, State & Zip Code <u>St. Rose, IL, 62230</u>		Municipality, State & Zip Code <u>Same</u>
	Telephone Number <u>618-526-4678</u>		Telephone Number <u>Same</u>
	Location of Facility Quarter Section Township Range <u>Sec 28 - Twp 3 - RNG 4 W 1/2 NE</u>		Municipality Township <u>St. Rose St. Rose</u>
	Street Address <u>8606 Main St.</u>		County Book Number <u>Clinton</u>
	Property Identification Number <u>01-01-28-200-001</u>		Parcel Number
	Sec. B  MANUFACTURING OPERATIONS	Nature of Operations Conducted at the Above Location <u>Dairy &amp; Grain Farming operation</u>	
Water Pollution Control Construction Permit No.		Date Issued	
NPDES PERMIT No.		Date Issued	Expiration Date
Air Pollution Control Construction Permit No.		Date Issued	
Air Pollution Control Operating Permit No.		Date Issued	
Sec. C  MANUFACTURING PROCESS	Describe Unit Process 		
	Materials Used in Process <u>Dairy operation - Feeds from cropland, commercial feeds and water fed to Dairy animals with the animal waste used as fertilizer for Cropland</u>		
Sec. D  POLLUTION CONTROL FACILITY DESCRIPTION	Describe Pollution Abatement Control Facility		
	<u>1.23 X 19 Round Glass Fused to steel Slurry storage</u> <u>248 X 52 Slotted floor over manure pits.</u>		

Sec. E	(1) Nature of Contaminants or Pollutants			
	CONTAMINANTS		Material Retained, Captured or Recovered	
		Contaminant or Pollutant	DESCRIPTION	DISPOSAL OR USE
		<i>Dairy Animal Waste</i>	<i>Cow Manure</i>	<i>Crop land</i>
		(2) Point(s) of Waste Water Discharge		
		<i>Protect livestock wastes from getting into Road ditches, streams, wells, on neighbor's property etc.</i>		
	Plans and Specifications Attached	Yes <input checked="" type="checkbox"/>	No <input type="checkbox"/>	
	(3) Are contaminants (or residues) collected by the control facility?	Yes <input checked="" type="checkbox"/>	No <input type="checkbox"/>	
	(4) Date installation completed _____ status of installation on date of application _____			
ACCOUNTING DATA	(5)	a. FAIR CASH VALUE IF CONSIDERED REAL PROPERTY:	\$	
		b. NET SALVAGE VALUE IF CONSIDERED REAL PROPERTY:	\$	
		c. PRODUCTIVE GROSS ANNUAL INCOME OF CONTROL FACILITY:	\$	
		d. PRODUCTIVE NET ANNUAL INCOME OF CONTROL FACILITY:	\$	
		e. PERCENTAGE CONTROL FACILITY BEARS TO WHOLE FACILITY VALUE:	% <i>70-80%</i>	
Sec. F	SIGNATURE			
	The following information is submitted in accordance with the Illinois Property Tax Code, as amended, and to the best of my knowledge, is true and correct. The facilities claimed herein are "pollution control facilities" as defined in Section 11-10 of the Illinois Property Tax Code.			
	<i>James Bucher Date 3-12-03 PRC's</i>			
	Signature	Title		
Sec. G	INSTRUCTIONS FOR COMPILING AND FILING APPLICATION			
	General: Separate applications must be completed for each control facility claimed. Do not mix types (water and air). Where both air and water operations are related, file two applications. If attachments are needed, record them consecutively on an index sheet.			
INSTRUCTIONS	Sec. A	Information refers to applicant as listed in the tax records and the person to be contacted for further details or for inspection of facilities. Define facility location by street address or legal description. A plat map location is required for facilities located outside of municipal boundaries. The property identification number is required.		
	Sec. B	Self-explanatory. Submit copies of all permits issued by local pollution control agencies. (e.g. MSD Construction Permit)		
	Sec. C	Refers to manufacturing processes or materials on which pollution control facility is used.		
	Sec. D	Narrative description of the pollution control facility, indicating that its primary purpose is to eliminate, prevent or reduce pollution. State the type of control facility. State permit number, date, and agency issuing permit. A narrative description and a process flow diagram describing the pollution control facility. Include a listing of each major piece of equipment included in the claimed fair cash value for real property. Include an <u>average</u> analysis of the influent and effluent of the control facility stating the collection efficiency.		
	Sec. E	List air contaminants, or water pollution substances released as effluents to the manufacturing processes. List also the final disposal of any contaminants removed from the manufacturing processes. Item (1) - Refers to pollutants and contaminants removed from the process by the pollution control facility. Item (2) - Refers to water pollution but can apply to water-carried wastes from air pollution control facilities. Submit drawings, which clearly show (a) Point(s) of discharge to receiving stream, and (b) Sewers and process piping to and from the control facility. Item (3) - If the collected contaminants are disposed of other than as wastes, state the disposition of the materials, and the value in dollars reclaimed by sale or reuse of the collected substances. State the cost of reclamation and related expense. Item (4) - State the date which the pollution control facility was first placed in service and operated. If not, explain. Item (5) - This information is essential to the certification and assessment actions. This accounting data must be completed to activate project review prior to certification by this Agency.		
	Sec. F	Self-explanatory. Signature must be a corporate authorized signature.		
	Submit to:	Attention:	Attention:	
	Illinois EPA P.O. Box 19276 Springfield, IL 62794-9276	Thomas McSwiggin Permit Section Division of Water Pollution Control	Donald E. Sutton Permit Section Division of Air Pollution Control	

STATE OF ILLINOIS

COUNTY OF SANGAMON

)  
)  
)  
)  
)

**PROOF OF SERVICE**

I, the undersigned, on oath state that I have served the attached APPEARANCE AND THE RECOMMENDATION, upon the person to whom it is directed, by placing a copy in an envelope addressed to:

Steve Santarelli  
Illinois Department of Revenue  
101 West Jefferson  
Post Office Box 19033  
Springfield IL 62794

Gervase Buehne  
8606 Main Street  
Breese IL 62230

and mailing it from Springfield, Illinois, on January 28, 2010, with sufficient postage affixed for first class mail.

And electronically, on January 28, 2010 to:

Clerk  
Illinois Pollution Control Board  
James R. Thompson Center  
100 West Randolph Street, Suite. 11-500  
Chicago IL 60601

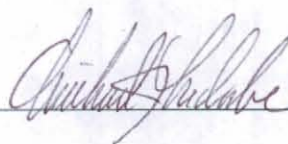

SUBSCRIBED AND SWORN TO BEFORE ME

This 28th day of January, 2010

  
Notary Public



**THIS FILING IS SUBMITTED ON RECYCLED PAPER**